

17 Mile



MANISTEE

SISSON LAKE

NATIONAL

FOREST

LAKE MAP SYMBOLS

OUTLINE & CONTOURS

— Shoreline

— 5 — Contours

SHORE FEATURES

— Improved road

W/ Marsh

W Wooded

TYPE OF LAKE BOTTOM Information Not Available

LILLEY LAKE

LAKE AREA 33 acres

LAKE AREA 58 acres

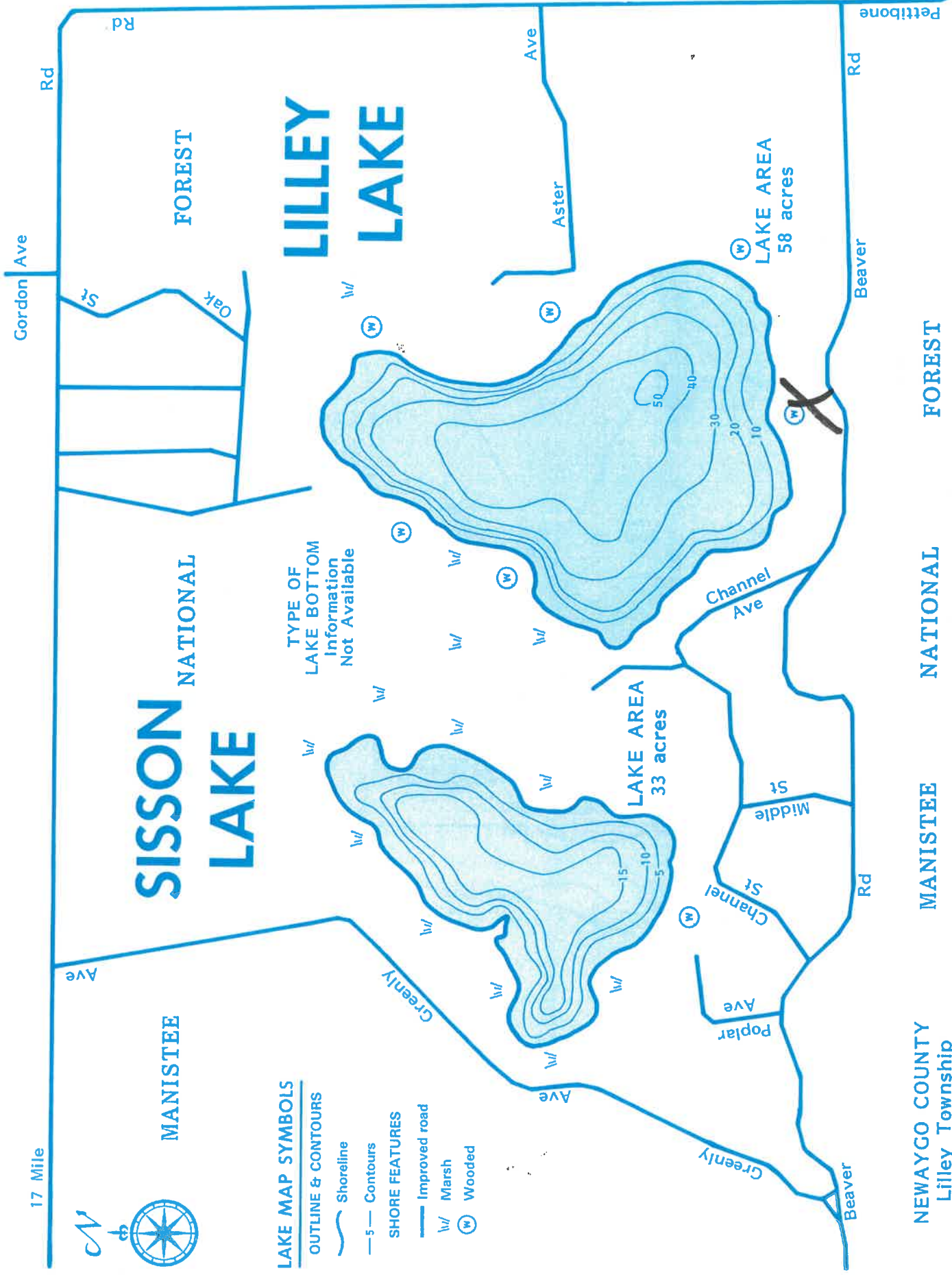

NEWAYGO COUNTY
Lilley Township
(See County Highway Map)

MANISTEE

NATIONAL

FOREST

19-8-7

R-9
 U.S. Department of Agriculture
 Forest Service
LAKE AND STREAM SURVEY
LILLEY LAKE
 Manistee National Forest
 Michigan

Area, 66.85 Acres
 Length of Shoreline 1.21 Miles

Location: Sec. 14, T. 21 N., R. 23 W.
 Scale: 1/8 inch = 1 mile

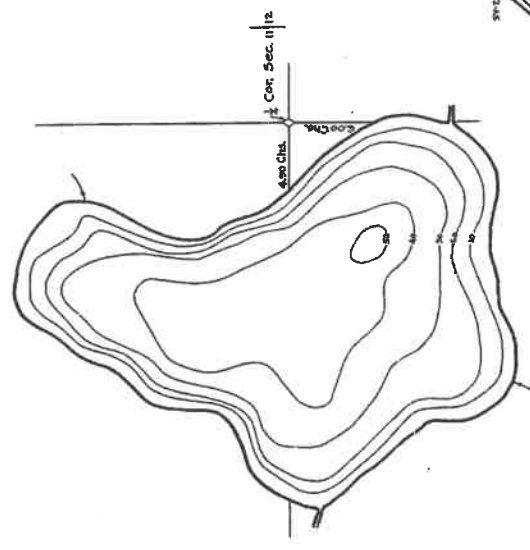

Contour Map
 Contour Interval = 10'

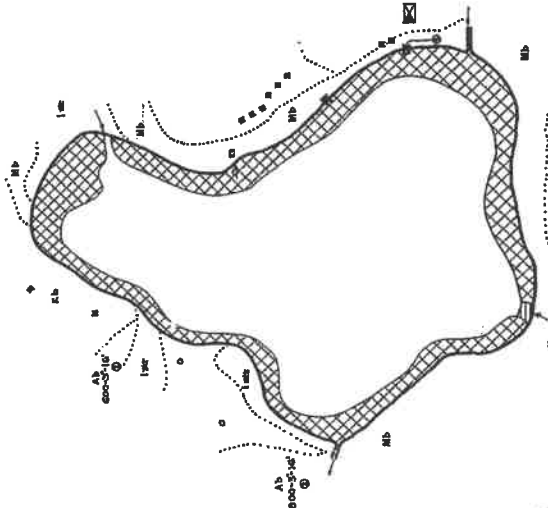

Cover Type And
 Lake Bottom Soil Type Map

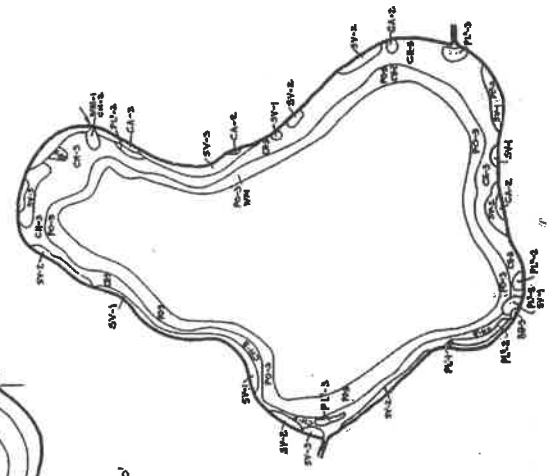

Aquatic Vegetation Map

1 - Bare
 2 - Common
 3 - Abundant

J-6-01
 12-1-54
 LILLEY LAKE, NEWAYGO COUNTY